



BoardTech



綠生活
建材

家碩防火建材有限公司

JIA sources Materials Ltd.

纖維水泥板 Fiber Cement Board

纖維水泥板原料為水泥、矽砂及高強度長纖維，經過高壓蒸氣養護 (Autoclave)，品質堅固尺寸穩定，並保證100%不含石棉致癌物質，非常合適應用於室內或室外的潮濕空間，通過CNS 6532耐燃一級及BS476 Part4不燃材料標準。

Hofmann Fiber Cement Board manufactured by modern technology, cement, silica and cellulose fiber are the main formulated materials. Every piece of Hofmann Fiber Cement Board is fully autoclaved, ensuring a high strength, stability and 100% NON-ASBESTOS quality products, which can be used in interior and exterior areas that may be subject to high moisture/humidity conditions. Noncombustible tests meet CNS 6532 class 1 and BS 476 part 4 standards.

纖維水泥板之特性 Properties of Fiber Cement Board

質輕，施工快速。Lightweight, Easy installation。

耐燃，不怕水，隔音效果佳。

Non-combustible, water damage-resistant, excellent sound insulation.

堅固，紮實，耐衝擊性優良。Solid, High-strength, Shock resistant。

表面可直接油漆，貼磁磚或大理石。Directly applied paint or tile or laminated marble as finishing。

降低基礎、結構以及整體工程成本。Light-weight wall system can reduce construction cost。

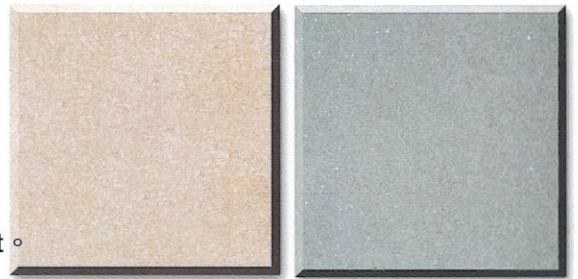

纖維水泥板之性能表 Mechanical Properties

種類 Product	厚度 Thickness mm	容積密度 Bulk Density Kg/cm ³	抗彎強度 Flexural Strength kgf/cm ²	彎曲破壞載重 kg f	吸水長度變化率 Length Change After Water Absorption %	熱傳導率 Thermal Conductivity (w/m.k)	耐燃性 Fire Resistance CNS 6532
1.0纖維水泥板 Fiber cement board	6 8 9 10 12	>1.0	>100	>20	0.16<	0.24<	耐燃一級 Class 1

纖維水泥板施工方法 Installations

乾式隔間牆 Drywall

安裝示意圖

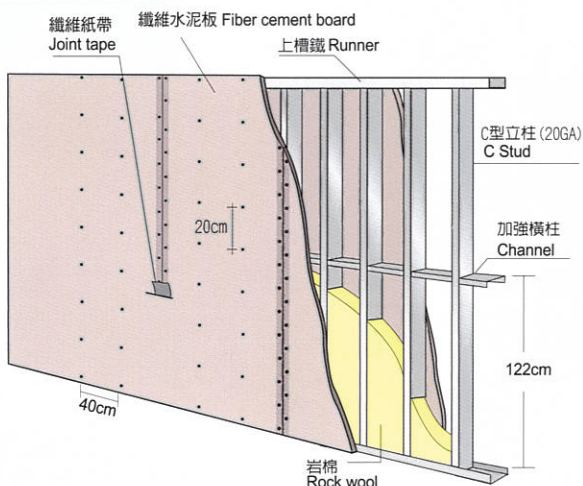

接縫處理 Joint treatment

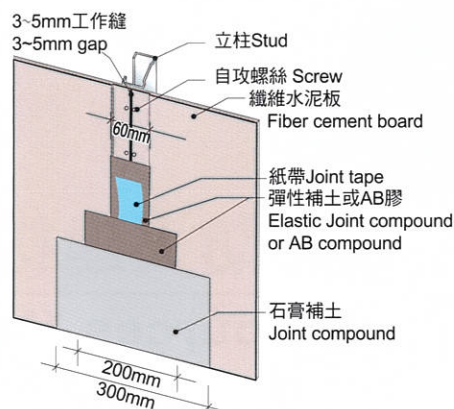

濕式隔間牆 Solid Wall

6 mm~12 mm纖維水泥板灌漿牆系統符合內政部2小時防火時效標準，具有絕佳之安全性。

Hofmann Fiber cement boards are made for drywall systems, solid wall systems and tiling wall systems. The 6mm ~ 12mm board-assembled solid wall system passed the two-hour fire rated test.

安裝示意圖

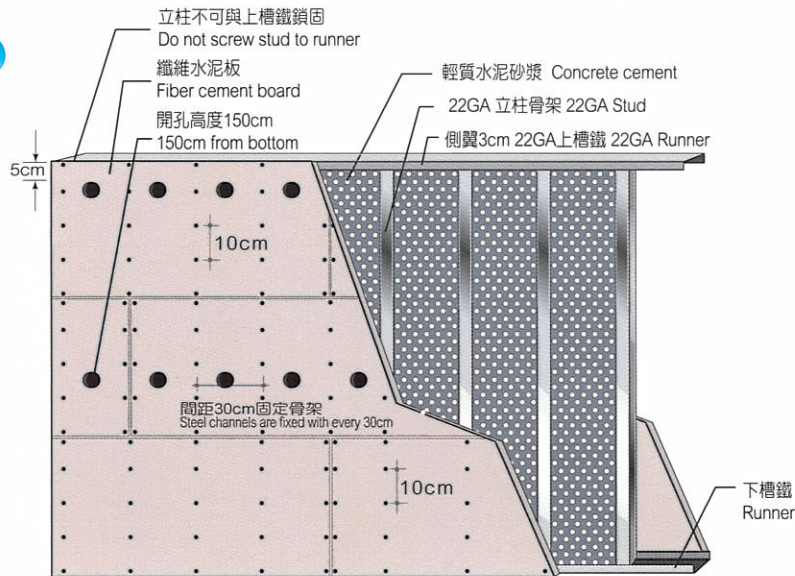

衛浴隔間牆 Tiling Wall

面貼磁磚或薄片石材，先將所有接縫及開孔，以防水材料填實，乾固後再以彈性高分子黏著劑黏貼。

Before tiling, all joints and openings should be filled with waterproof filler. After curing, apply tile adhesive for tiling work.

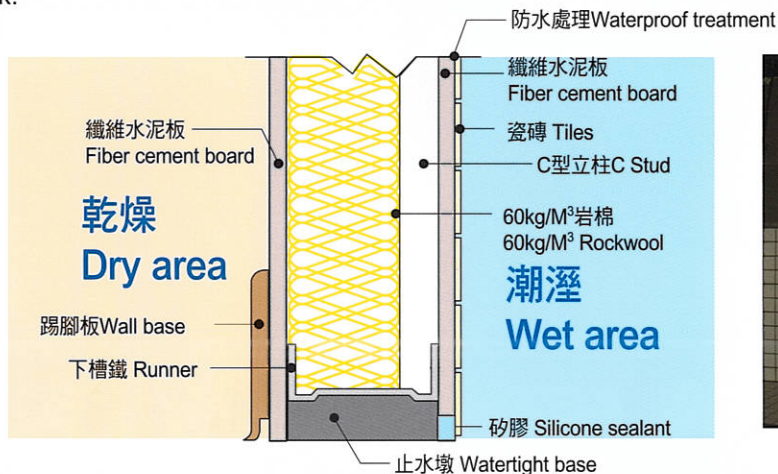



BoardTech
保時捷

家碩防火建材有限公司

JIA sources Materials Ltd.

40757 台中市西屯區市政路500號19樓之8
19F.-8, No.500, Shizheng Rd., Xitun Dist., Taichung City 407, Taiwan (R.O.C.)
TEL:04-22595561 FAX:04-22583882

166 Wyckham Road, Castle Bromwich, Birmingham, B36 0HU England
Tel: +44 121 748 4954 Fax: +44 121 240 5218
E-mail: info@jia-sources.com

